

LAKE NONA®



LAKE NONA TOWN CENTER II

13485 Veteran's Way | Orlando, FL 32827



TAVISTOCK
DEVELOPMENT COMPANY

CLASS A
OFFICE SPACE
FOR LEASE

FOR MORE INFO, CONTACT:

GINGER VETTER
C: (407) 619-5245 | D: (407) 816-6686
gvetter@tavistock.com



LAKE NONA TOWN CENTER II



TAVISTOCK
DEVELOPMENT COMPANY

CLASS A
OFFICE SPACE
FOR LEASE

FOR MORE INFO, CONTACT:

GINGER VETTER
C: (407) 619-5245 | D: (407) 816-6686
gvetter@tavistock.com

1ST FLOOR

Parking Garage

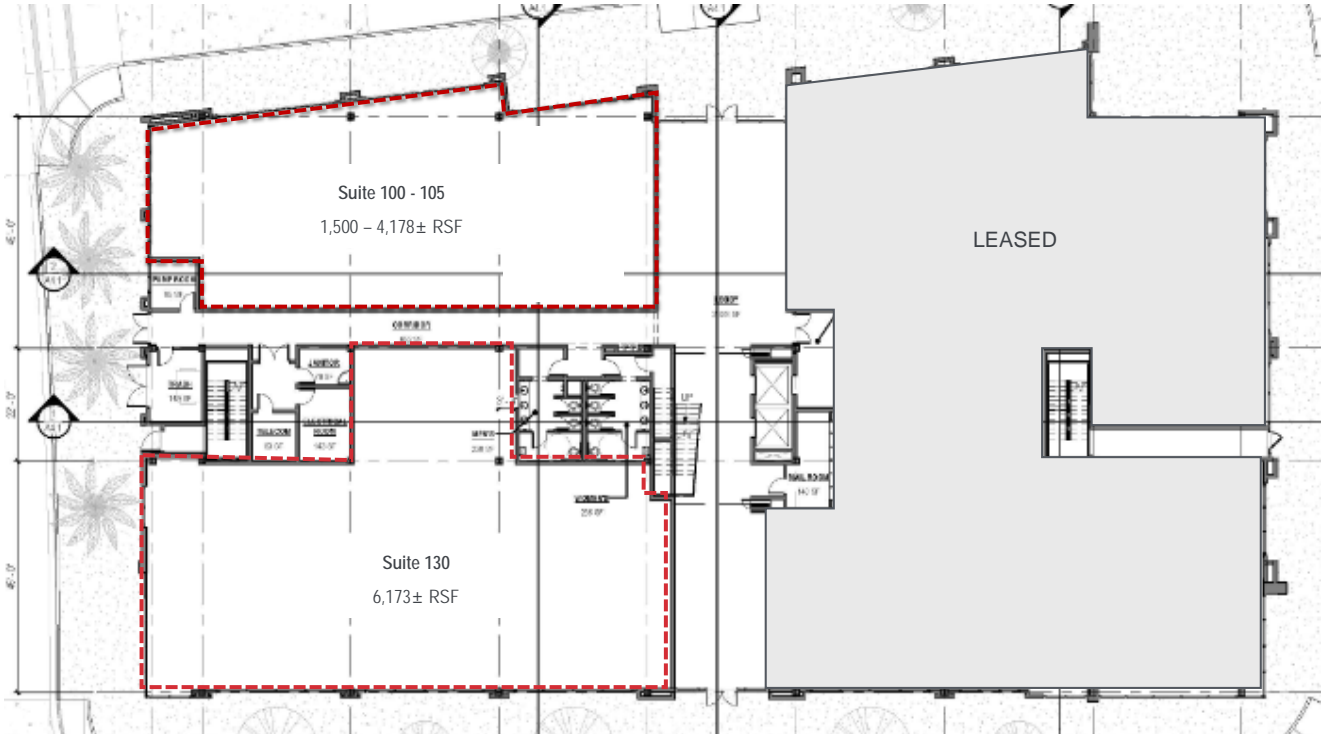

Veteran's Way

LAKE NONA TOWN CENTER II: AVAILABLE SPACE



TAVISTOCK
DEVELOPMENT COMPANY

CLASS A
OFFICE SPACE
FOR LEASE

FOR MORE INFO, CONTACT:

GINGER VETTER
C: (407) 619-5245 | D: (407) 816-6686
gvetter@tavistock.com

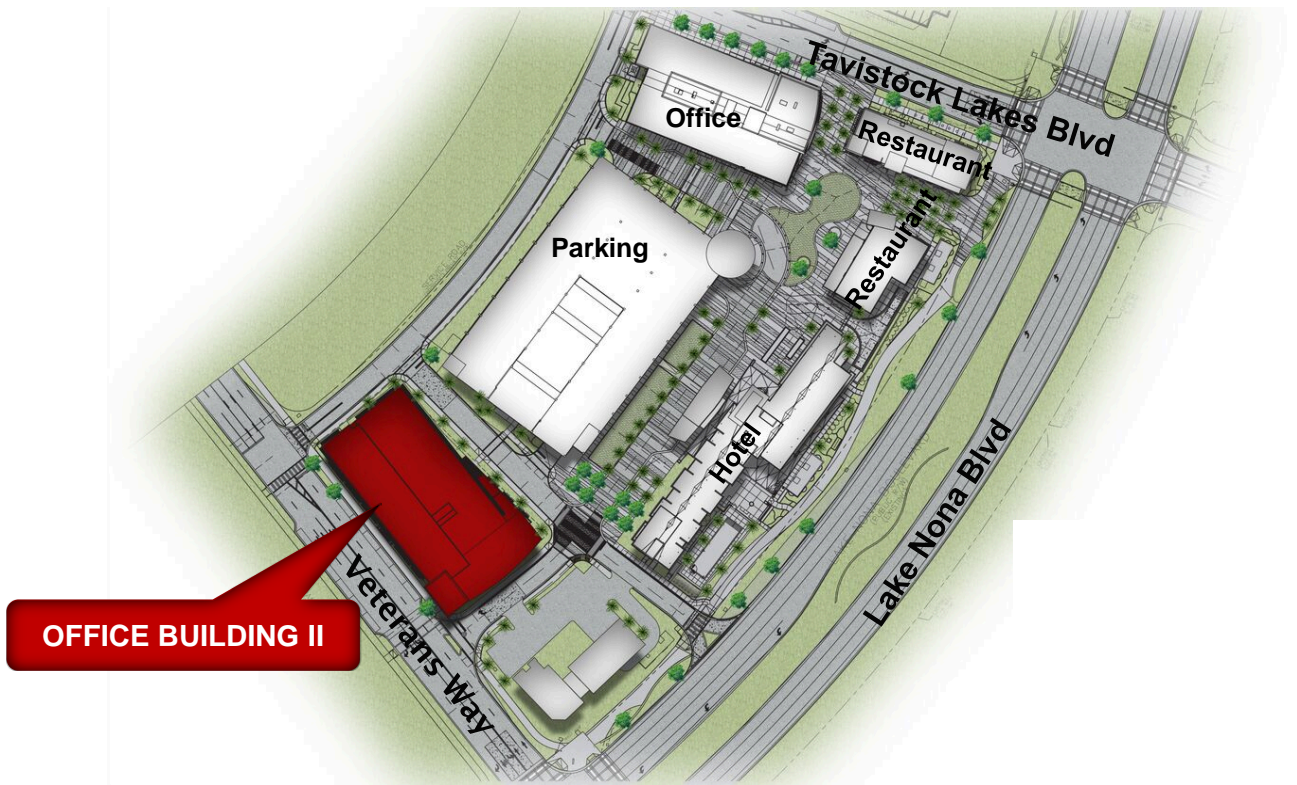

LAKE NONA TOWN CENTER II

155,694 RSF Class A Office Building

PROPERTY FEATURES

- Newly-constructed, six-story, multi-tenant office building
- 27,000± SF floor plates
- Class-A space with upgraded finishes throughout
- Beautifully landscaped plaza with outdoor seating, restaurants and entertainment
- Parking in multi-level garage free of charge to tenants
- Adjacent to 204-room, Residence Inn & Courtyard by Marriott
- In walking distance to state-of-the-art medically integrated wellness and fitness center, restaurants, and retail
- Easy access to SR 417, SR 528, Florida's Turnpike and minutes from Orlando Int'l Airport
- Multiple housing options nearby



TAVISTOCK
DEVELOPMENT COMPANY

CLASS A
OFFICE SPACE
FOR LEASE

FOR MORE INFO, CONTACT:

GINGER VETTER
C: (407) 619-5245 | D: (407) 816-6686
gvetter@tavistock.com



LAKE NONA TOWN CENTER



- Located in the heart of Lake Nona, Lake Nona Town Center will become a premier entertainment destination.
- Lake Nona Town Center will feature a total of more than 6,000,000 SF of retail, dining, hospitality, and office space at build out.



TAVISTOCK
DEVELOPMENT COMPANY

CLASS A
OFFICE SPACE
FOR LEASE

FOR MORE INFO, CONTACT:

GINGER VETTER
C: (407) 619-5245 | D: (407) 816-6686
gvetter@tavistock.com